

## Parts Included



Small Mix Tip (1)



Coyote Adhesive 50cc

Manufactured for



7450 W. Lemhi, Boise, Idaho 83709  
(800) 819-5980 or (208) 429-0026  
[www.coyotedesign.com](http://www.coyotedesign.com)



CD4150.revA.012213



# CD4150

## 50cc Coyote Quick Adhesive



Made in U.S.A.

External Prosthetic Components



EC REP

Advena, Ltd.  
Thorne Widgery House,  
33 Bridge Street, Hereford  
HR4 9DQ, UK

## Installing Lock on Mold

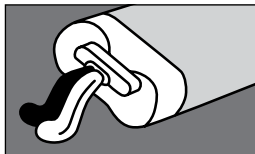

- 1** Purge the cartridge. Snip off the tip. Insert cartridge into dispenser gun. Expel a small amount of adhesive to purge the cartridge.

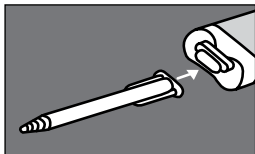

- 2** Install mix tip. Line up mix tip appropriately and twist into place.

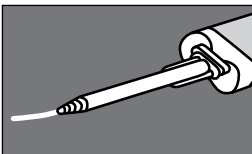

- 3** Run a test bead approx. 1" in length. Store unused portion by leaving the mix tip on when done.

## Parts Sold Separately

**CDDMA51 Dispenser is required for use (sold separately)**

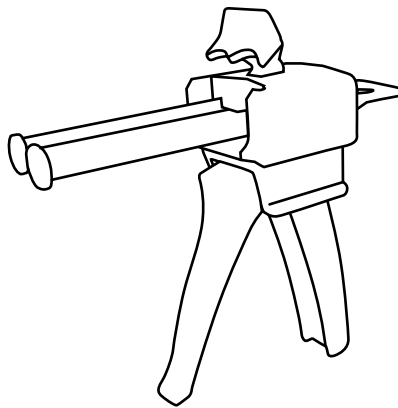

Contact coyote for a MSDS for this product.  
(208) 429-0026 or [mailbox@coyotedesign.com](mailto:mailbox@coyotedesign.com)

## CAUTION

1. Read carefully BEFORE applying adhesive to ensure proper adhesion.
2. Quick Adhesive sets extremely fast. To ensure a proper bond, work very quickly. Refrigerate the cartridge to slow down work time.