

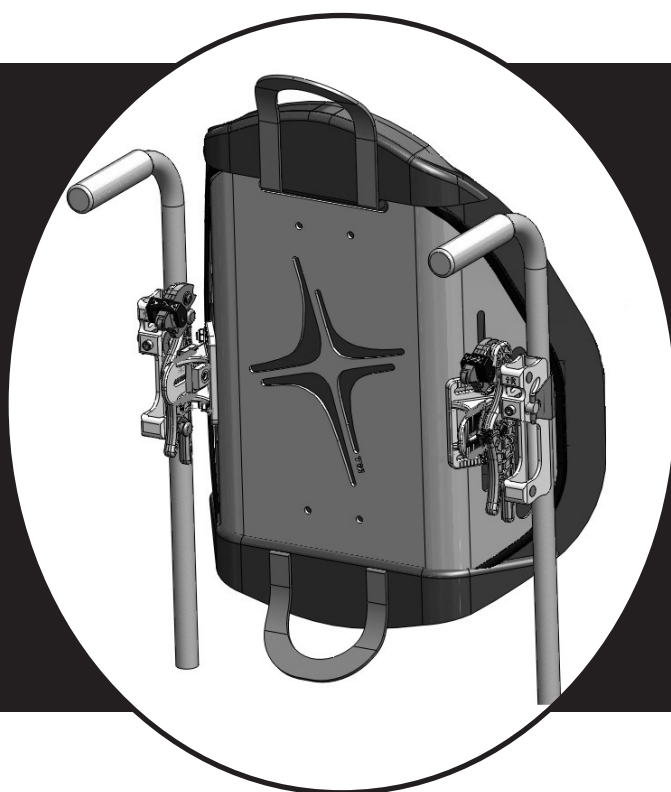

# ROHO AGILITY™

## Back System



## ROHO® AGILITY™ Back Systems

### OPERATION MANUAL

SUPPLIER: This manual must be given to the user of this product.

USER: Before using this product, read instructions and save for future reference.

Visit [www.therohogroup.com](http://www.therohogroup.com) to view the contents of this document in additional languages.

ESPAÑOL: Visite [www.therohogroup.com](http://www.therohogroup.com) para ver el contenido de este documento en otros idiomas.

FRANÇAIS: Visitez le [www.therohogroup.com](http://www.therohogroup.com) pour voir le contenu de ce document dans différentes langues.

DEUTSCH: Besuchen Sie [www.therohogroup.com](http://www.therohogroup.com), um den Inhalt dieses Dokuments in weiteren Sprachen anzuzeigen.

ITALIANO: Visitare [www.therohogroup.com](http://www.therohogroup.com) per visualizzare i contenuti del presente documento nelle altre lingue.

NEDERLANDS: Ga naar [www.therohogroup.com](http://www.therohogroup.com) om de inhoud van dit document in andere talen te bekijken.

DANSK: Besøg [www.therohogroup.com](http://www.therohogroup.com) for at se indholdet af dette dokument på andre sprog.

SVENSKA: Besök [www.therohogroup.com](http://www.therohogroup.com) för att visa innehållet i detta dokument i ytterligare språk.

NORSK: Besøk [www.therohogroup.com](http://www.therohogroup.com) for å se innholdet i dette dokumentet på flere språk.

SUOMI: Käy osoitteessa [www.therohogroup.com](http://www.therohogroup.com) nähdäksesi tämän asiakirjan sisällön muilla kielillä.

PORTUGUÊS: Visite [www.therohogroup.com](http://www.therohogroup.com) para exibir o conteúdo deste documento em outros idiomas.



## TABLE OF CONTENTS

INTENDED USE	2
INFORMATION FOR SAFETY	2-3
PARTS DETAIL	4-5
PRODUCT SPECIFICATIONS	5-6
BACK CANE HARDWARE INSTALLATION AND REMOVAL	7
AGILITY INSTALLATION AND REMOVAL	8-9
FLIP BACK SHELL	9
WIDTH ADJUSTMENT	10
HEIGHT ADJUSTMENT	11
DEPTH AND ANGLE ADJUSTMENT	12
COVER REMOVAL AND INSTALLATION	13
COVER COMPONENTS - REMOVAL AND INSTALLATION	13-14
COVER COMPONENTS - AIR INSERT ADJUSTMENT	15
ACCESSORIES	16
CLEANING AND DISINFECTING	17
MAINTENANCE, DISPOSAL AND TROUBLESHOOTING	18
RETURN POLICY, CONTACT INFORMATION AND LIMITED WARRANTY	19
ESPAÑOL	20
FRANÇAIS	39

ROHO, Inc. has a policy of continual product improvement and reserves the right to amend this document. The current version of this document is available at [www.therohogroup.com](http://www.therohogroup.com).



ROHO® AGILITY™ Back Systems are manufactured by ROHO, Inc.,

100 North Florida Avenue, Belleville, Illinois 62221-5429

[www.therohogroup.com](http://www.therohogroup.com)

U.S.A.: 1-800-851-3449, Fax 1-888-551-3449 e-mail: [cs@therohogroup.com](mailto:cs@therohogroup.com)

Outside the U.S.A.: 1-618-277-9150, Fax 1-618-277-6518 e-mail: [intl@therohogroup.com](mailto:intl@therohogroup.com)

© 2012, 2014 ROHO, Inc.

The following are trademarks and registered trademarks of ROHO, Inc.: ROHO®, AGILITY™, and shape fitting technology®.

Zytel® is a registered trademark of DuPont.

Products in this manual may be covered by one or more U.S. and foreign patents and trademarks. For further details please refer to [www.therohogroup.com](http://www.therohogroup.com).

## INTENDED USE

ROHO® AGILITY™ Back Systems (AGILITY) are removable backrest replacement systems for wheelchairs, designed to provide trunk/pelvis support and positioning to the individual. AGILITY include:



- ROHO® AGILITY™ Minimum Contour Back System (AGILITY Minimum Contour)
- ROHO® AGILITY™ Mid Contour Back System (AGILITY Mid Contour)

AGILITY have a weight limit of 300 lbs. (136 kg).

ROHO, Inc. recommends that a clinician, such as a doctor or therapist experienced in seating and positioning, be consulted to determine if an AGILITY is appropriate for the individual's particular seating needs.

## INFORMATION FOR SAFETY - GENERAL WARNINGS

### WARNINGS

- **DO NOT** operate AGILITY without first reading and understanding this manual. If assistance is needed, contact a clinician, ROHO provider or ROHO, Inc.
- In addition to information in this manual, individuals with an AGILITY installed on a wheelchair must continue to follow the wheelchair manufacturer's instructions.
- When using any back system, it is especially important to inspect the skin, especially those areas covering bony prominences, which are at greater risk for breakdown. If any discoloration (ie. redness, bruising, purple, or darker areas versus normal skin tone, which may be the beginning sign of skin breakdown) is noted and does NOT disappear within 30 minutes after removal from the product, discontinue use and consult a healthcare provider immediately.
- AGILITY should be installed by a qualified and competent healthcare professional.
- AGILITY must be sized correctly to the individual and the wheelchair.
- As with any addition to a wheelchair, AGILITY may affect the stability of the wheelchair. Before using an AGILITY, ROHO, Inc. recommends that a clinician evaluate the need for possible wheelchair modifications.
- **DO NOT** lean over the top of AGILITY. This may cause a change in center of gravity and the wheelchair could tip over.
- Use caution when installing, adjusting, or removing AGILITY hardware to avoid pinching or trapping fingers in openings.
- AGILITY is not intended for individuals weighing over 300 lbs. (136 kg).
- Check AGILITY screws, clamps, and brackets for wear, breakage, and tightness daily. Retighten loose screws following the instructions throughout this manual. **DO NOT** continue to use an AGILITY if any part cannot be tightened or is broken. ROHO, Inc. recommends that an AGILITY be thoroughly inspected periodically by a qualified technician.
- **DO NOT** attach, remove or adjust the width of an AGILITY when an individual is seated in the chair.
- **DO NOT** use an AGILITY to lift or push a wheelchair. Doing so may cause the back system to become unintentionally detached from the wheelchair. Ensure both left and right safety locks are in the LOCKED () position prior to the individual being seated in the chair and remain in the LOCKED () position while the individual is seated in the chair.
- AGILITY is compatible with many wheelchairs that are angularly adjustable, recline or tilt and result in a back angle up to and including 60 degrees. Beyond 60 degrees, AGILITY may not be an appropriate selection. Use with wheelchairs that angularly adjust, recline or tilt to a back angle greater than 60 degrees may cause AGILITY to accidentally disconnect from the wheelchair, resulting in a fall and the potential for serious injury. Consult a clinician to determine if AGILITY is compatible with the individual's wheelchair.

## INFORMATION FOR SAFETY - GENERAL CAUTIONS



### CAUTIONS

- AGILITY is intended to be used with an AGILITY cover, foam pad, lumbar support pad (if applicable), and either the air insert or the foam insert (if applicable). The air insert and the foam insert are not intended to be used together.
- Protect AGILITY from blunt force shocks that may cause damage and/or breakage.
- Use of any hardware or components, other than those supplied by ROHO, may void the warranty. If replacement parts are needed, contact a ROHO provider.
- Unless otherwise stated in this manual, AGILITY is not intended to be used with, and has not been tested for use with, other manufacturers' accessories.
- The components of AGILITY are not intended to be used separately, or in conjunction with, other wheelchair back systems.
- Altering AGILITY may affect its performance and void the warranty.
- Metal components may become hot if exposed to high temperatures or cold if exposed to low temperatures.
- AGILITY may need to be removed from the wheelchair prior to folding the wheelchair.
- The U.S. Environmental Protection Agency, Health Canada, and other government agencies have issued warnings regarding the use of ozone generators. Prolonged exposure to ozone may degrade some materials used in the manufacture of this product, and may affect the performance of this product and void the product warranty.

## INFORMATION FOR SAFETY - MOTOR VEHICLE TRANSPORTATION



**CAUTION:** Whenever possible, the individual in the wheelchair with an AGILITY should transfer into a manufacturer-installed vehicle seat and use the vehicle's crash-tested occupant restraint system.

AGILITY with Quick Release Attachment Hardware has been dynamically tested for use in a motor vehicle by a third-party testing facility.	
Initial frontal impact test set-up included: <ul style="list-style-type: none"><li>• AGILITY 20 in. (51 cm) in height</li><li>• Surrogate: ISO/RESNA wheelchair frame (SWCF); metal seat; four-point, strap-type tie-down; and SWCF-anchored three-point belt</li><li>• Hybrid III mid-size male seated facing forward and torso upright</li></ul>	Additional testing with AGILITY positioned 6.5 in. (16.5 cm) below the shoulders included: <ul style="list-style-type: none"><li>• AGILITY 13 in. (33 cm) in height</li><li>• Surrogate: SWCF @ 18" with metal pan; SWTORS; and WC-anchored lap belt</li><li>• Back cane hardware mounted both behind and in front of the back canes during separate test set-ups</li></ul>
Testing, as described above, concluded that AGILITY meets all criteria for wheelchair seating systems proposed in Section 5.1.1 of Section 20 ANSI/RESNA/ WC/Volume 4 "Wheelchair Seating Systems for Use in Motor Vehicles".	



### WARNINGS

- Failure to pay attention to these warnings could result in severe injury to the individual in the wheelchair or to others.
- AGILITY must be correctly and securely installed on the wheelchair following all instructions and warnings provided in this operation manual.
- AGILITY should be installed on a wheelchair so the individual is seated in an upright position and the wheelchair is facing forward during transportation in a motor vehicle. AGILITY has only been crash tested on a wheelchair in the forward facing position per the test information provided above.
- AGILITY must only be used with wheelchairs that comply with the performance requirements of ISO 7176-19 and that are installed, used and maintained according to the wheelchair manufacturer's instructions.
- The wheelchair with an AGILITY must be used with an effective wheelchair securement system and a properly positioned, crash-tested pelvic and shoulder-belt restraint, or Wheelchair Tiedown and Occupant Restraint System (WTORS), following manufacturer's instructions.
- The top of AGILITY should be positioned as close to the top of the shoulder as possible to provide good support in the event of a crash. The distance between the top of the user's shoulder and the top of the back should not exceed 6.5 in. (16.5 cm).
- If an AGILITY is involved in a motor vehicle accident, see MAINTENANCE in this manual.

For additional information on motor vehicle testing of AGILITY, visit [www.therohogroup.com](http://www.therohogroup.com).

## PARTS DETAIL

### Package Contents:

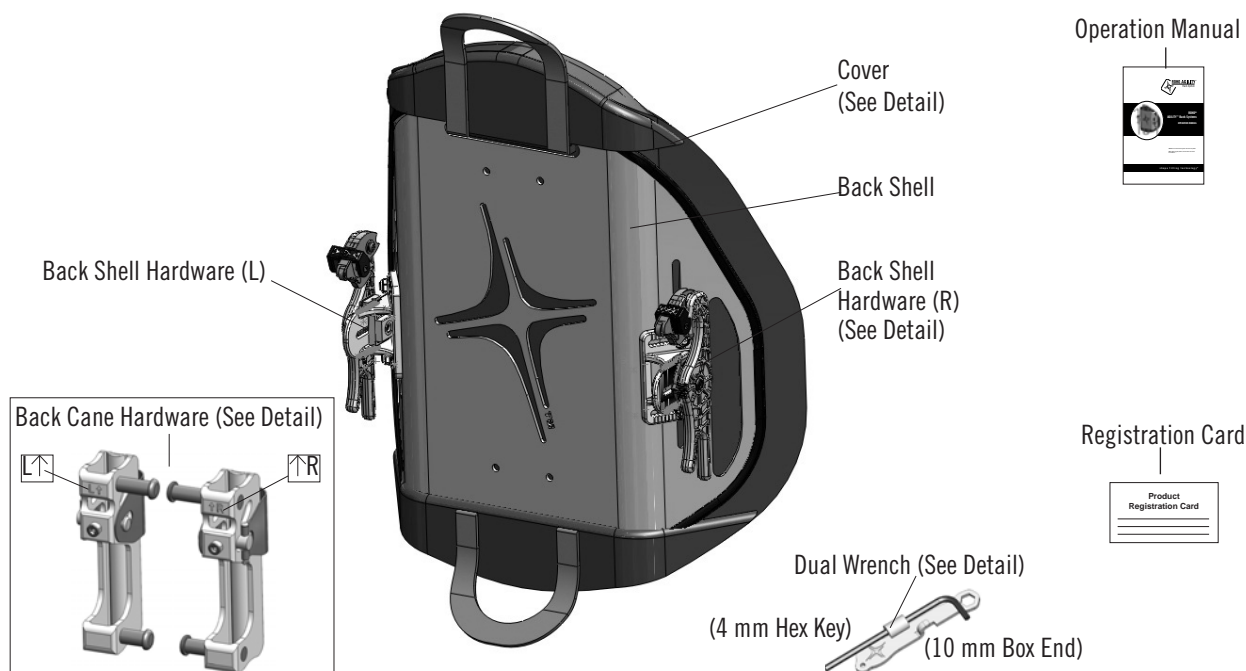

### Additional Package Contents depending on model:



**Note:** A tape measure or ruler is recommended, but not included in the package contents.

### Back Shell Hardware Detail - Right (R) shown:

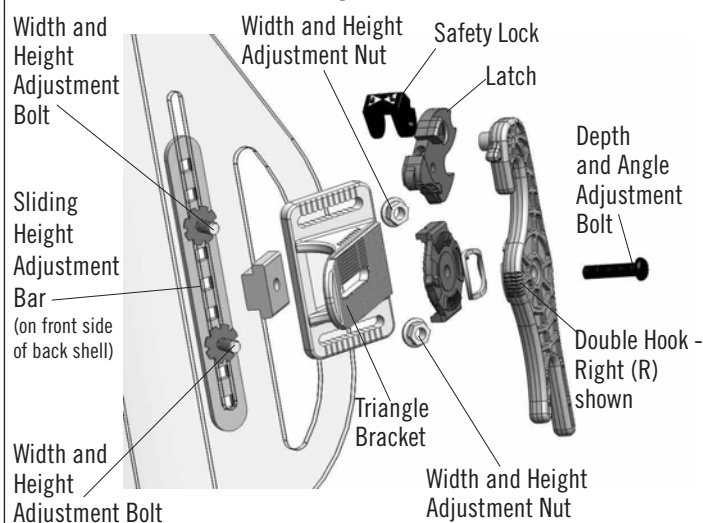

### Back Cane Hardware Detail - Right (↑R), Standard shown:

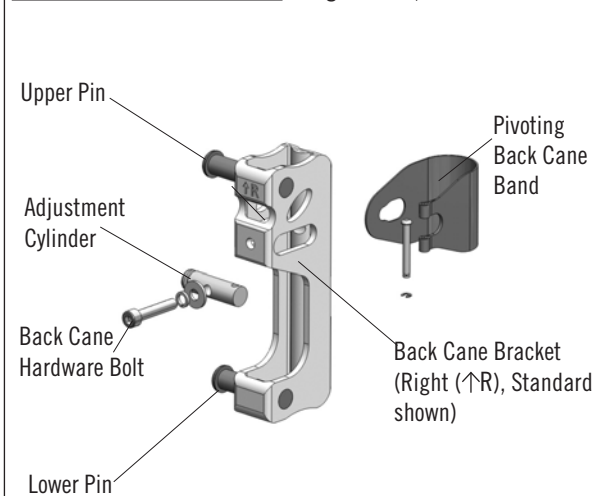

### Dual Wrench Detail - To separate and assemble for use as an Allen Wrench:

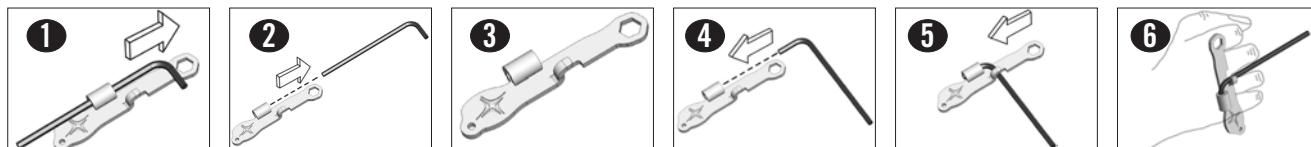

## PARTS DETAIL CONTINUED

### Cover Components Detail:

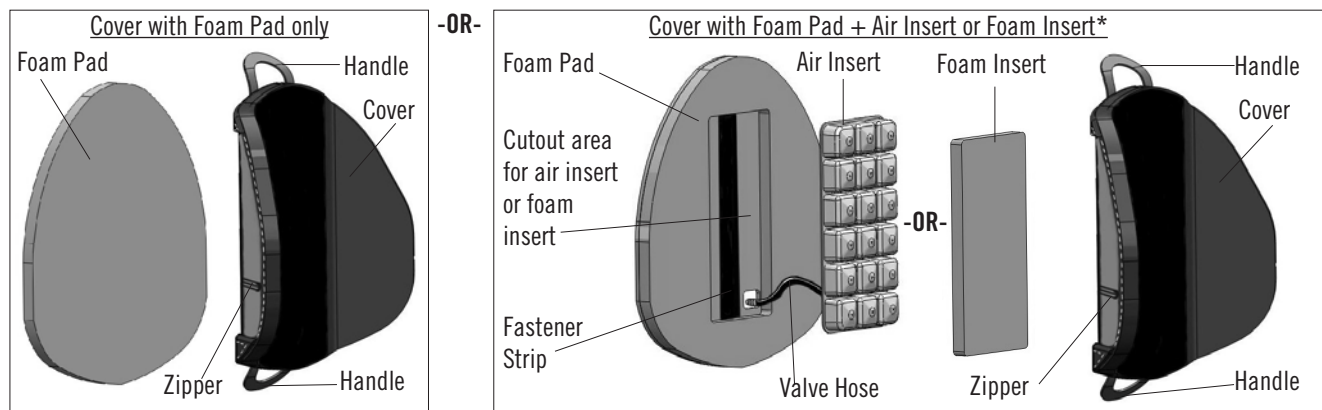

**\*Note:** The air insert and the foam insert are not intended to be used together.

To order replacement parts: In the U.S.A., contact the ROHO Customer Service Department, call your product provider or visit [www.therohostore.com](http://www.therohostore.com). Outside the U.S.A., contact your country's ROHO International distributor.

## PRODUCT SPECIFICATIONS\*

### Materials:

#### Cover:

Front Side: Polyester  
Back Side: Polyurethane foam coated nylon/polyurethane coated polyester  
Flaps: Polyurethane-coated polyester  
**Lumbar Support Pad:** Polyurethane

#### Foam Pad:

Front Side: Polyurethane  
Back Side: Polyethylene  
**Foam Insert:** Polyurethane  
**Air Insert:**  
Front Side: Polyether polyurethane  
Back Side: Urethane film coated nylon

#### Back Shell: Aluminum

#### Back Shell Hardware: Zytel®

Sliding Height Adjustment Bar: Aluminum

#### Back Cane Hardware:

Back Cane Bracket: Aluminum  
Pivoting Cane Band and Adjustment Cylinder: Steel

AGILITY complies with CAL 117, EN 1021-1 and EN 1021-2 flammability requirements.

### Wheelchair Compatibility:



#### WARNINGS:

AGILITY is compatible with many wheelchairs that are angularly adjustable, recline or tilt and result in a back angle up to and including 60 degrees. Beyond 60 degrees, AGILITY may not be an appropriate selection. Use with wheelchairs that angularly adjust, recline or tilt to a back angle greater than 60 degrees may cause AGILITY to accidentally disconnect from the wheelchair, resulting in a fall and the potential for serious injury. Consult a clinician to determine if AGILITY is compatible with the individual's wheelchair.

Rigidizer bars may pose a mounting challenge. See TROUBLESHOOTING. Make sure the rigidizer bar does not interfere with any of the back cane hardware components.

**Note:** If the back cane brackets are installed on the front side of the back canes, there will be up to 1 in. (2.5 cm) of additional seat depth loss.

AGILITY is designed to be used with most wheelchairs that have back canes described in the BACK CANE BRACKET COMPATIBILITY chart.

AGILITY must be sized correctly to the wheelchair and may not fit every wheelchair. Consult with the provider or clinician providing your equipment to determine if your wheelchair and back canes are compatible with AGILITY.

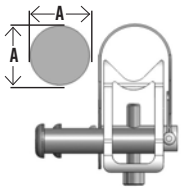
BACK CANE BRACKET COMPATIBILITY					
Back Cane Bracket (Top View)		Adjusts to Fit Back Cane Diameters (A)			
		Smallest		Largest	
		in.	(cm)	in.	(cm)
Standard Fits Circular Back Canes		0.75	(2.0)	1.0	(2.5)

**\*NOTE:** All measurements are approximate.

## PRODUCT SPECIFICATIONS\* CONTINUED

AGILITY WIDTH (W)		ADJUSTS TO FIT WHEELCHAIR WIDTHS			
		Smallest**		Largest	
in.	(cm)	in.	(cm)	in.	(cm)
14.0	(35.5)	13.0	(33.0)	14.0	(35.5)
16.0	(40.5)	15.0	(38.0)	16.0	(40.5)
18.0	(45.5)	17.0	(43.0)	18.0	(45.5)
20.0	(51.0)	19.0	(48.5)	20.0	(51.0)

Width (W) measurements are taken from the outside of the back cane to the outside of the back cane.  
 \*\*There will be a 0.5 in. (1.5 cm) loss of seat depth if an AGILITY is fitted to the smallest wheelchair width within each size range.

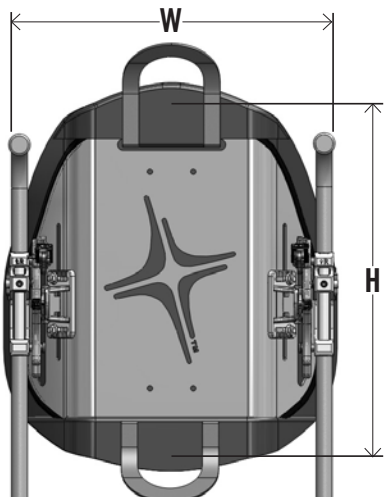
	AGILITY HEIGHT (H)		ADJUSTABLE AIR INSERT HEIGHT		
	in.	(cm)	in.	(cm)	# Cells
	10.0	(25.5)	6.5	(16.5)	3
	13.0	(33.0)	10.5	(27.0)	5
	16.0	(40.5)	12.5	(32.0)	6
	18.0	(45.5)	14.5	(37.0)	7
	20.0	(51.0)	16.5	(42.0)	8
Height (H) measurements are taken from center edge to center edge between the narrow and wide ends of the back shell. Note: Cover assembly not included in height measurement.			All air inserts: • Width: 3 cells, 6.5 in. (16.5 cm) • Perimeter: 0.25 in. (1.0 cm) included in height and width measurements • Cell height: 1.25 in. (3.0 cm) when fully inflated		

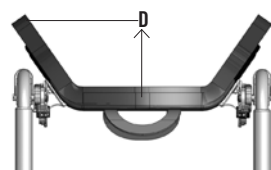
AGILITY DEPTH (D) AND WEIGHT RANGE						
AGILITY Model	Depths and weights are based on (W x H): 14 in. x 10 in. (35.5 cm x 25.5 cm), 16 in. x 16 in. (40.5 cm x 40.5 cm), and 20 in. x 18 in. (51.0 cm x 45.5 cm) AGILITY Minimum Contour models. 14 in. x 10 in. (35.5 cm x 25.5 cm), 16 in. x 16 in. (40.5 cm x 40.5 cm), and 20 in. x 20 in. (51.0 cm x 51.0 cm) AGILITY Mid Contour models.					
	Least		Average		Greatest	
	DEPTH					
	Depth (D) measurements are taken from the highest point of a contoured edge of the cover to the center, front surface of a cover assembled with an air insert inflated to allow 0.5 in. (2.5 cm) immersion. Depth of foam only models will be 0.5 in. (2.5 cm) less.					
	in.	(cm)	in.	(cm)	in.	(cm)
	AGILITY Minimum Contour	3.0	(7.5)	3.0	(7.5)	3.5
AGILITY Mid Contour	3.75	(9.0)	4.0	(10.0)	4.25	(11.0)
	WEIGHT					
	Weight ranges do not include Back Cane Hardware. Pair of Back Cane Hardware with Standard Bracket: 0.75 lbs. (0.30 kg)					
	lbs.	(kg)	lbs.	(kg)	lbs.	(kg)
AGILITY Minimum Contour	2.5	(1.1)	4.0	(1.8)	5.25	(2.3)
AGILITY Mid Contour	2.5	(1.2)	4.25	(1.9)	6.0	(2.8)

\*NOTE: All measurements are approximate.



## BACK CANE HARDWARE INSTALLATION

**Notes:** The existing wheelchair back should be removed from the wheelchair following the wheelchair/wheelchair back manufacturer's directions. Make sure the wheelchair back canes are clean before installing the back cane hardware. Apply wheelchair brakes before installing back cane hardware. Back cane hardware is pre-assembled as left (L↑) and right (↑R). For demonstration purposes, only left (L↑) assembly may be shown below.

**! WARNING: DO NOT install AGILITY back cane hardware with the individual in the chair.**

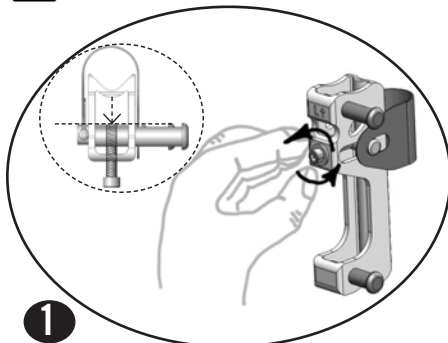

**1** Loosen the back cane hardware bolt as shown. **Note:** The bolt should **NOT** disengage from the adjustment cylinder.

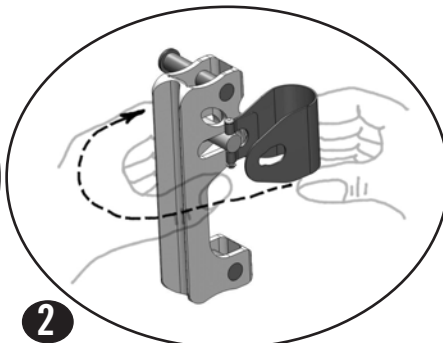

**2** Press the end of the adjustment cylinder and unclip the pivoting back cane band. Rotate the back cane bracket away from the back cane band.

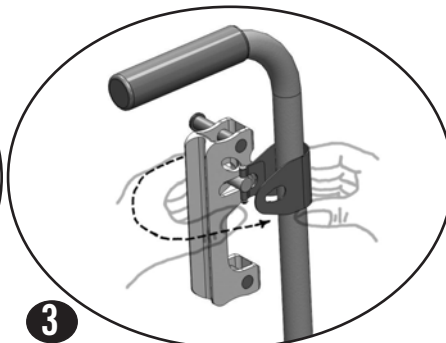

**3** Hold the pivoting back cane band against the back cane and rotate the back cane bracket to press against the back cane.

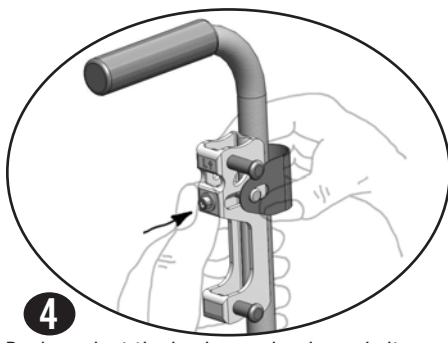

**4** Push against the back cane hardware bolt with thumb and clip the opening of the pivoting back cane band around the end of the adjustment cylinder. Position the narrow end of the cane band's opening into the groove at the end of the adjustment cylinder.

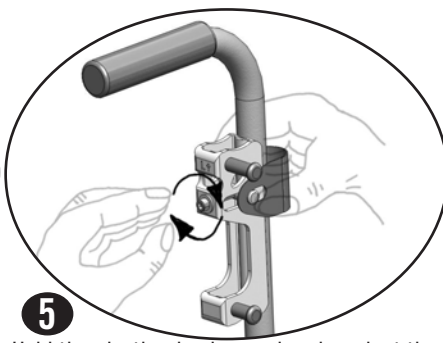

**5** Hold the pivoting back cane band against the back cane and tighten back cane hardware bolt by hand until the adjustment cylinder is pulled forward against back cane. (Repeat steps 1 to 5 for opposite back cane hardware.)

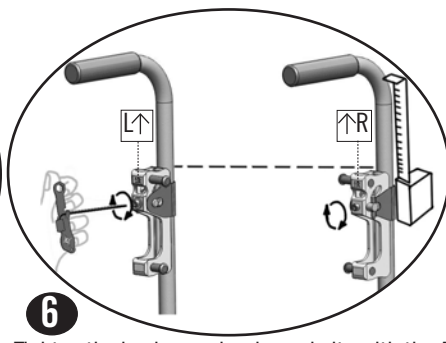

**6** Tighten the back cane hardware bolts with the Allen wrench until snug + one-quarter turn. **Note:** If torque wrench available, tighten to no more than 40 inch-pounds (4.5 Newton-meters).

**! IMPORTANT!** Make sure the upper and lower pins of each back cane bracket are aligned with each other, both brackets are installed on the correct side, and the height of both brackets is equal.

## BACK CANE HARDWARE REMOVAL

**Note:** Remove the AGILITY from the wheelchair prior to removing the back cane hardware. SEE AGILITY REMOVAL.

**! WARNING: DO NOT remove AGILITY or the back cane hardware with the individual in the chair.**

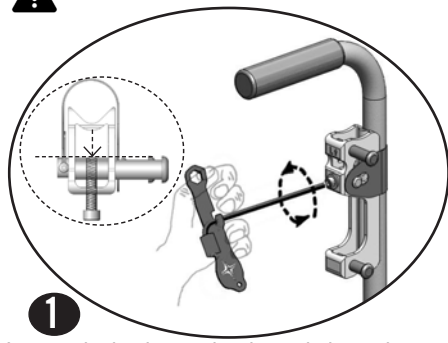

**1** Loosen the back cane hardware bolt as shown. **Note:** The bolt should **NOT** disengage from the adjustment cylinder.

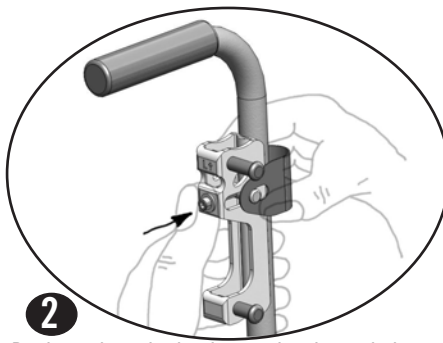

**2** Push against the back cane hardware bolt with thumb and pry pivoting back cane band away from adjustment cylinder groove.

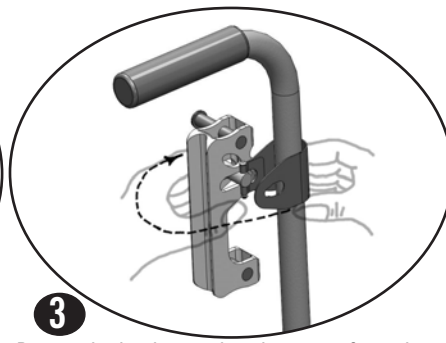

**3** Rotate the back cane bracket away from the back cane.

## AGILITY INSTALLATION

**Note:** Safety locks must be in the **UNLOCKED** (🔓) position to install the AGILITY.

**⚠️ WARNING:** DO NOT attach the AGILITY with the individual seated in the wheelchair.

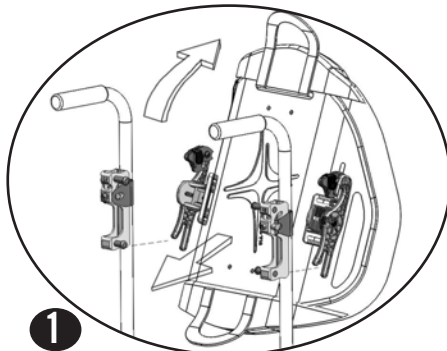

**1**  
Tilt the top of the back shell toward the front of the chair.

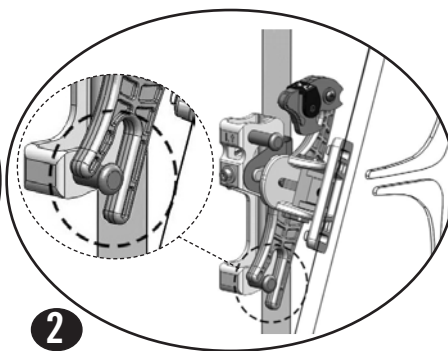

**2**  
Hook the lower ends of double hooks onto the lower pins of the back cane brackets.

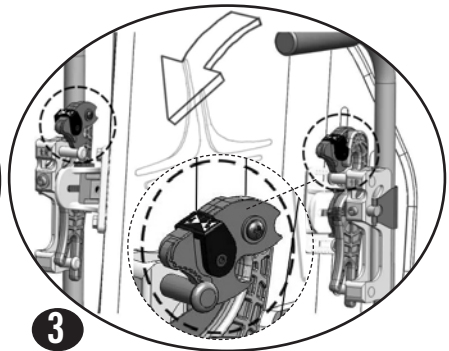

**3**  
Tilt the back shell toward the back canes until the latches rest on upper pins.

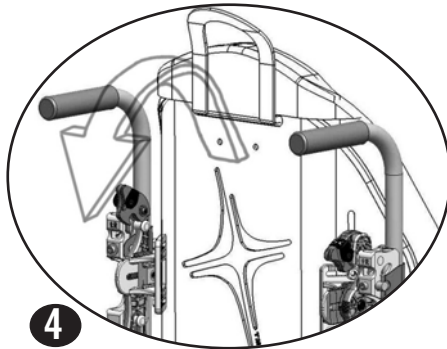

**4**  
Slightly lift the back shell up then tilt it backwards toward the back canes. **Note: DO NOT** lift the back shell up so far that the lower ends of the double hooks clear the lower pins. Lower ends of the double hooks should remain positioned over the lower pins.

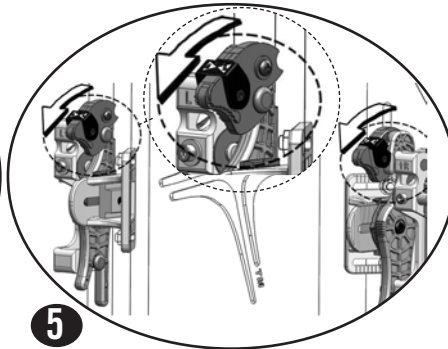

**5**  
Push down on the back shell until the mouths of the latches open and the upper ends of double hooks wrap around the upper pins. Latches should now be all the way down in the closed position.

**⚠️ IMPORTANT!** Make sure both latches are fully closed. If latches will not close, or back shell hardware will not hook to the upper and lower pins of the back cane bracket, see TROUBLESHOOTING.

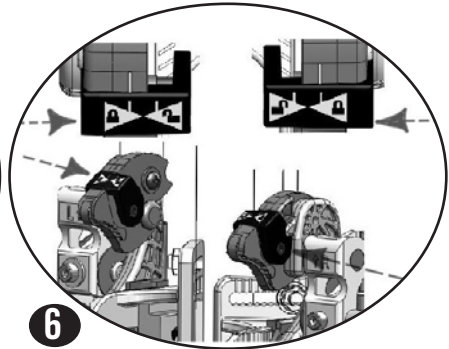

**6**  
Lock the latches by pushing both the left and right safety locks toward the center of the back shell into the **LOCKED** (🔒) position.

**⚠️ WARNING:** Make sure both left and right safety locks are in the **LOCKED** (🔒) position prior to the individual being seated in the chair. To test locks, use the handle to pull up on AGILITY.

### **⚠️ WARNINGS:**

**DO NOT** use the handle to pull the wheelchair with the individual seated in the wheelchair. The handle is intended only to assist with the installation and removal of AGILITY from the wheelchair.

Ensure both left and right safety locks are in the **LOCKED** (🔒) position prior to the individual being seated in the chair and remain in the **LOCKED** (🔒) position while the individual is seated in the chair.

Once installation is complete, make sure all hardware is securely tightened prior to the individual being seated. Refer to appropriate sections in this manual for recommended torque specifications. If adjustments are needed, have individual transfer out of the chair if required, adjust as necessary, and re-tighten all hardware prior to the individual being seated.

## AGILITY INSTALLATION CONTINUED

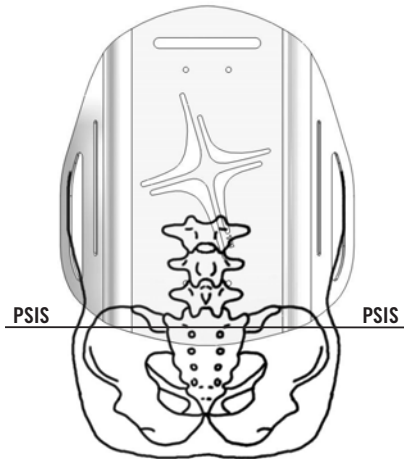

### Posterior, Superior, Iliac Spine (PSIS):

**! WARNING:** If the AGILITY is not positioned to make contact at the PSIS, pelvic support and trunk control may be reduced.

ROHO, Inc. recommends that the bottom portion of an AGILITY be positioned to make contact at the PSIS for optimal pelvic support and trunk control.

## AGILITY REMOVAL

**! WARNING:** DO NOT remove the AGILITY with the individual seated in the wheelchair.

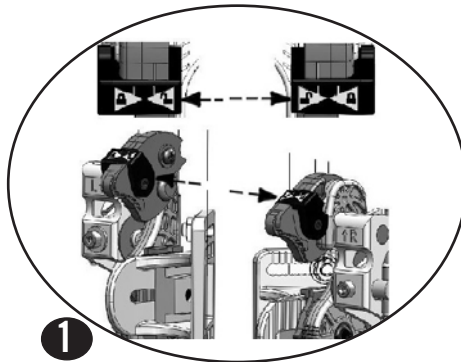

**1**  
UNLOCK (🔓) the safety locks.

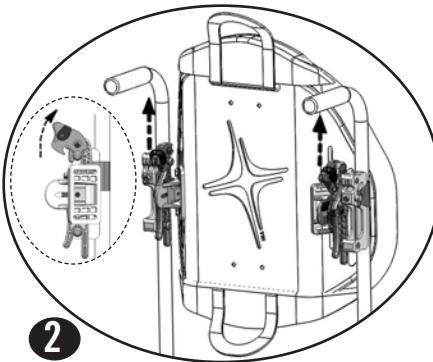

**2**  
Open the left and right latches by pulling the latches up.

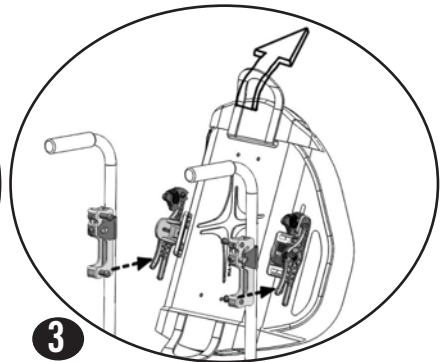

**3**  
Use the top handle to slightly lift the AGILITY up and remove it from the wheelchair.

## FLIP BACK SHELL

**Note:** AGILITY must be removed from the wheelchair before flipping positions.

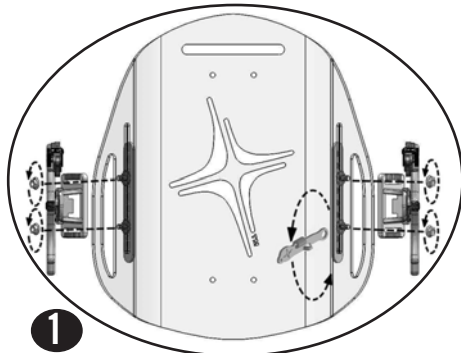

**1**  
Remove the nuts at the end of the width and height adjustment bolts with the box end wrench. Detach the triangle brackets from the back shell.

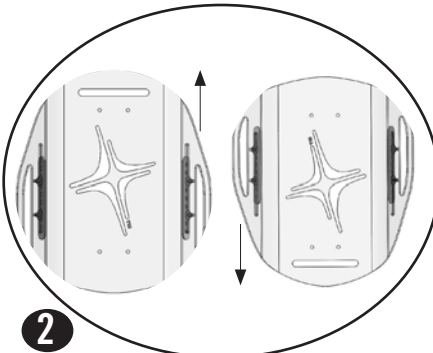

**2**  
Rotate the back shell to wide or narrow top.

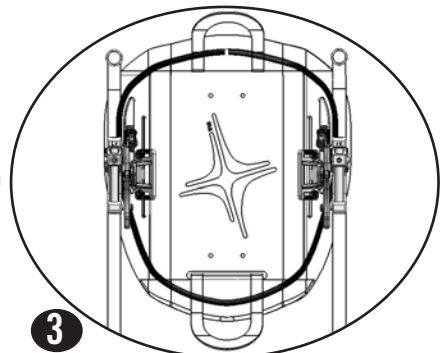

**3**  
See all ADJUSTMENT and INSTALLATION sections in this manual.

## WIDTH ADJUSTMENT

**! WARNINGS:** DO NOT remove the AGILITY with the individual in the chair.  
DO NOT adjust the width of an AGILITY with the individual in the chair.

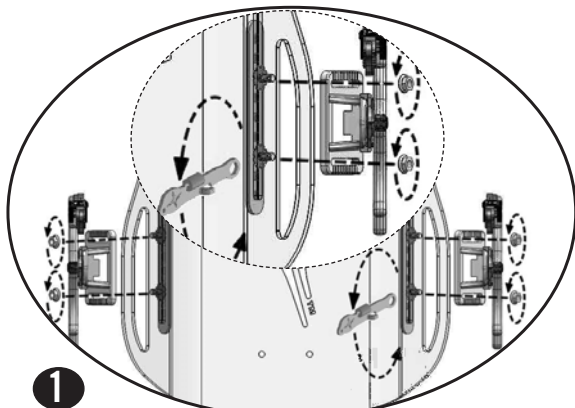

See WIDTH ADJUSTMENT **WARNINGS** at the top of this page. Remove AGILITY from the wheelchair before adjusting the width. Remove the nuts at the end of the width and height adjustment bolts with the box end wrench. Detach the triangle brackets from the back shell.

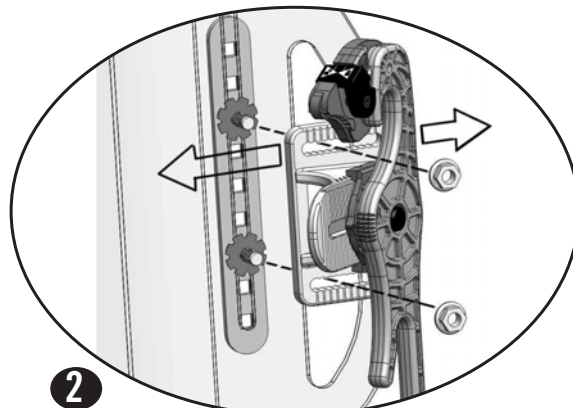

Refer to the AGILITY Sizing Guide to determine which grooves on the top and bottom of the triangle brackets match the desired AGILITY width position. At the desired groove location, slide the triangle bracket horizontal slots over the flat end of the width and height adjustment bolts.

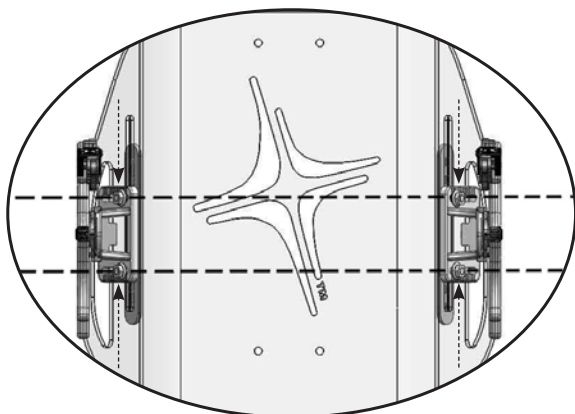

**! IMPORTANT!** Use the reference grooves on the triangle brackets to make sure that the width and height adjustment bolts are in the same position within the horizontal slots in the triangle brackets.

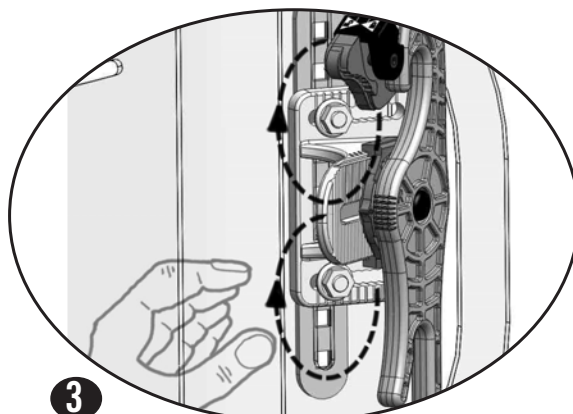

Replace the nuts on the width and height adjustment bolts. With the left (L) and right (R) back shell hardware positioned at equal heights, tighten the nuts so they are snug enough to hold the hardware in place. Use the box end wrench if necessary. If height adjustment is needed, proceed to HEIGHT ADJUSTMENT section.

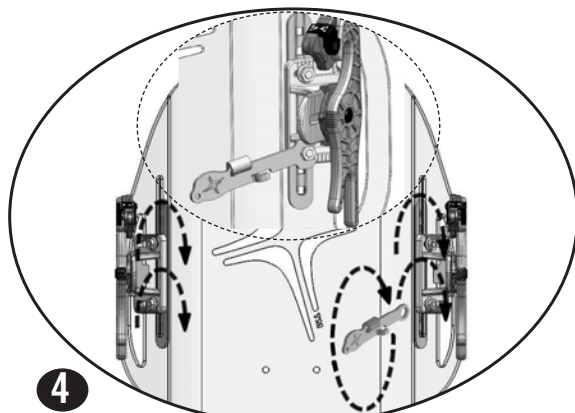

Tighten the nuts on the width and height adjustment bolts with the box end wrench until snug + one-quarter turn. **Note:** If torque wrench available, tighten to 42 +/- 2 inch-pounds (4.75 +/- 0.25 Newton-meters).

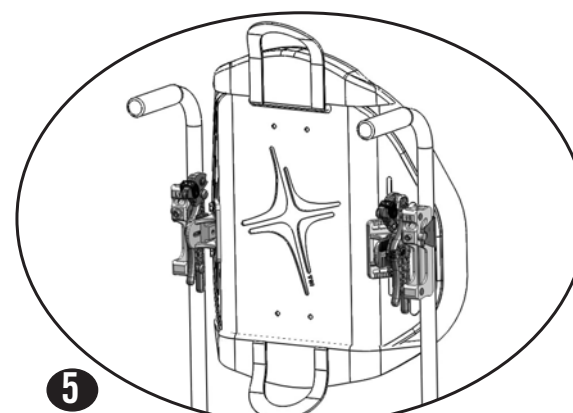

Install AGILITY on the wheelchair. See AGILITY INSTALLATION.

**! WARNING:** Once adjustment is complete, make sure all hardware is securely tightened before the individual is seated in the wheelchair.



## HEIGHT ADJUSTMENT

**! WARNING:** Height adjustments can be made with the individual in the chair if performed with caution. Make sure wheelchair wheels are locked, AGILITY safety locks are in the LOCKED (🔒) position, and all hardware is securely tightened before the individual is seated in the chair.

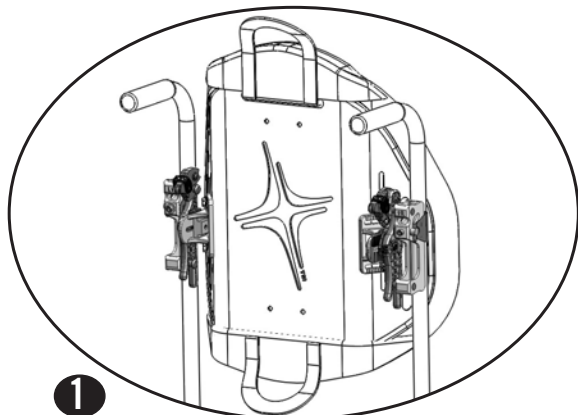

**1**  
Install the AGILITY on the wheelchair. See AGILITY INSTALLATION. The individual may be seated in the chair. See HEIGHT ADJUSTMENT **WARNING** at the top of this page.

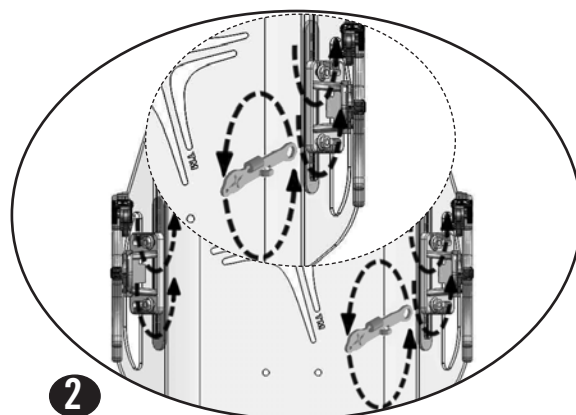

**2**  
Loosen the nuts on the width and height adjustment bolts with the box end wrench.

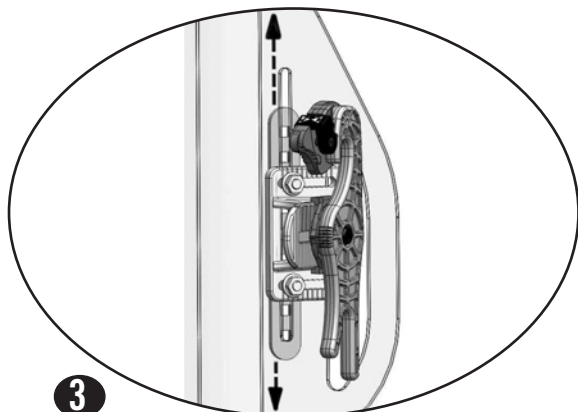

**3**  
Slide the back shell up and down in the vertical slots until the desired height is achieved.

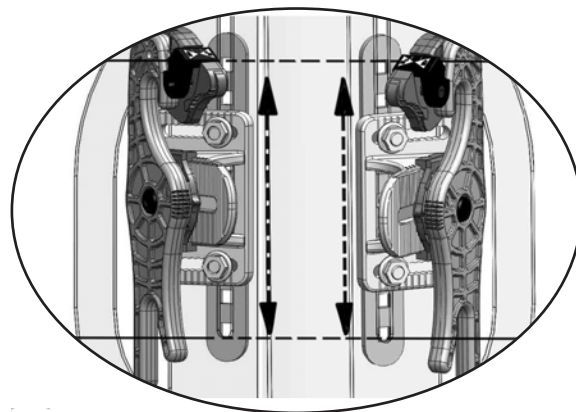

**! IMPORTANT!** In the sliding height adjustment bar, count the number of square slots that are visible through the vertical slots in the back shell to make sure that the left (L) and right (R) back shell hardware are in the same position.

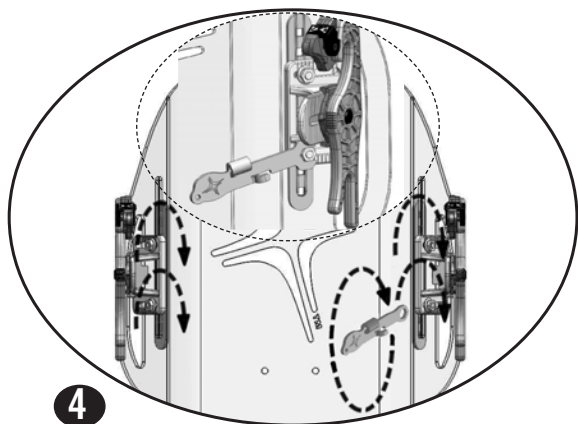

**4**  
Tighten the nuts on the width and height adjustments bolts with the box end wrench until snug + one-quarter turn. **Note:** If torque wrench available, tighten to 42 +/- 2 inch-pounds (4.75 +/- 0.25 Newton-meters).

**! WARNING:** Once adjustment is complete, make sure all hardware is securely tightened.

## DEPTH AND ANGLE ADJUSTMENT

**Note:** AGILITY must be installed on the wheelchair before adjusting the seat depth and angle.

### WARNINGS:

Depth and angle adjustments can be made with the individual in the chair, if performed correctly and with caution. If the installer finds it too difficult or unsafe to make depth and angle adjustments with the individual in the chair, have the individual transfer safely out of the chair.

Make sure the wheelchair wheels are locked, the AGILITY safety locks are in the LOCKED (🔒) position, and all hardware is tight before the individual is seated in the chair.

DO NOT rotate the depth and angle adjustment bolts more than three (3) full rotations. If the depth and angle adjustment bolts are over-rotated, components of the back shell hardware will begin to disassemble, preventing the bolt from being tightened securely. Transfer the individual out of the chair immediately if over-rotation of the bolt occurs. Contact ROHO, Inc. for instruction on re-assembly of the back shell hardware. See CONTACT INFORMATION.

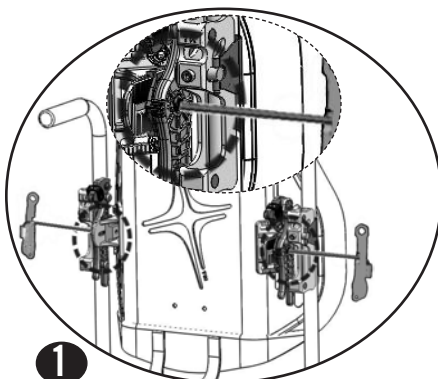

**1**

See **WARNINGS** at the top of this page.

Loosen the left and right depth and angle adjustment bolts with the Allen wrench:

- 2 to 3 full rotations **TO ADJUST THE SEAT DEPTH**
- 1 to 2 full rotations **TO ADJUST THE ANGLE** only

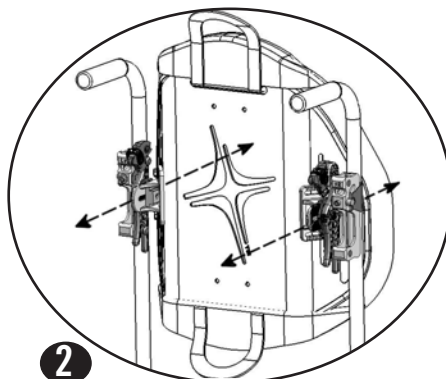

**2**

**TO ADJUST THE SEAT DEPTH:** Slide the back shell forward or backward to the desired depth. **Note:** If triangle bracket will not slide, see TROUBLESHOOTING.

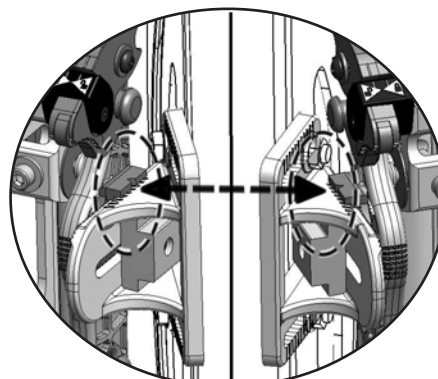

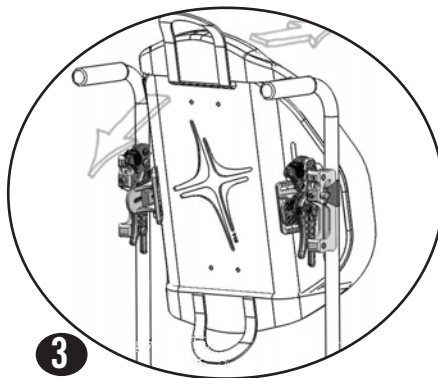

 **IMPORTANT!** Make sure the depth positions on the left and right sides are equal by comparing the markers on the top of the triangle brackets.

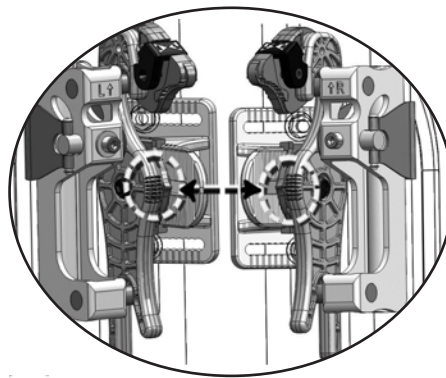

**3**

**TO ADJUST THE ANGLE:** Pivot the back shell back and forth until desired incline or decline is achieved.



 **IMPORTANT!** Make sure the left (L) and right (R) double hooks are rotated to the same angle by comparing the markers on the front of the double hooks.

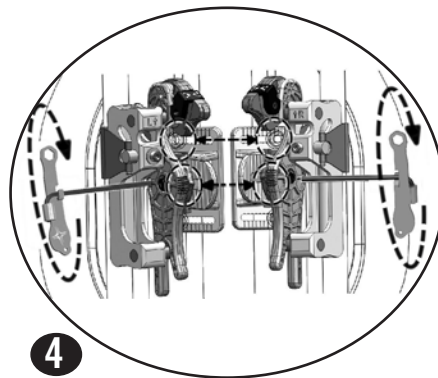

**4**

Hold the back shell in position. Tighten right and left depth and angle adjustment bolts with the Allen wrench until snug + one-quarter turn. **Note:** If torque wrench available, tighten to 60 +/- 4 inch-pounds (7 +/- 0.5 Newton-meters).

 **WARNING:** Once depth and angle adjustment is complete, make sure all hardware is securely tightened. Refer to appropriate sections in this manual for recommended torque specifications. If individual is seated in the chair and depth and angle re-adjustments are needed, see **WARNINGS** at the beginning of this section and re-adjust as necessary. Re-tighten all hardware securely.

## COVER REMOVAL AND INSTALLATION

**⚠ WARNING:** DO NOT remove or install the AGILITY cover with the individual in the chair.  
DO NOT use the AGILITY without the cover, foam pad, and, if applicable, the air insert or foam insert, in place.

### TO REMOVE THE COVER:



**1** On the back side of the back shell's wide end, release the fastener strips between the cover flap and the back shell.



**2** Beginning at the wide end, pull the cover away from the back shell releasing it from the fastener strips on the front side of the back shell.



**3** Flip the cover completely over the narrow end of back shell.

On the front of the back shell's narrow end, release the fastener strips between the cover flap and the back shell.

Pull the flap from the horizontal slot in the back shell.

### TO INSTALL THE COVER:

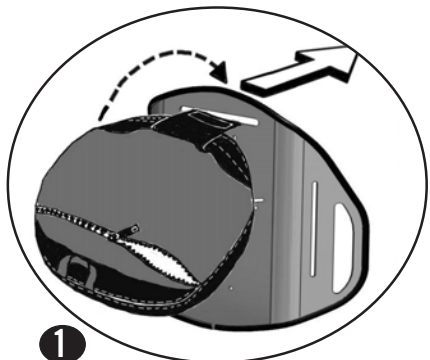

**1** From the back side of the back shell, push the flap through the horizontal slot on back shell's narrow end.

Press fastener strips on the flap and back shell together.

Flip the cover over the narrow end of the back shell.



**2** Make sure the zipper side of the cover is toward the back shell.

Secure the back side of the cover to the fastener strips on the front side of the back shell.



**3** Pull the wide end of the cover over the wide edge of the back shell.

Press the fastener strips on the cover flap and back shell's wide end together.

## COVER COMPONENTS - REMOVAL

### TO REMOVE THE FOAM PAD, AIR INSERT OR FOAM INSERT:

1. Unzip the cover.
2. Remove the foam pad from inside the cover with the air insert or foam insert, if applicable, still attached.
3. Detach the insert from the fastener strip in the cutout area of the foam pad.
4. If the air insert attached, pull the valve hose back through the hole in the foam pad.

## COVER COMPONENTS - INSTALLATION

### TO INSTALL THE FOAM PAD:

1. Unzip the cover and place the foam pad into the cover.  
Note: The wide and narrow ends of the foam pad should be aligned with the wide and narrow ends of the cover.
2. Zip the cover closed.
3. Install the cover on the back shell.

### TO INSTALL THE FOAM PAD WITH AIR INSERT:

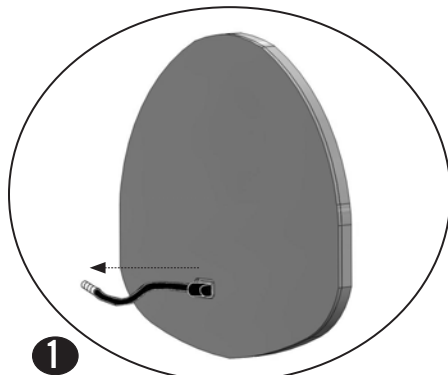

**1** With the fabric back of the air insert facing the cutout area of the foam pad, align the air insert's valve hose with the hole in the corner of the cutout area. Slide the air insert's valve hose through the hole.

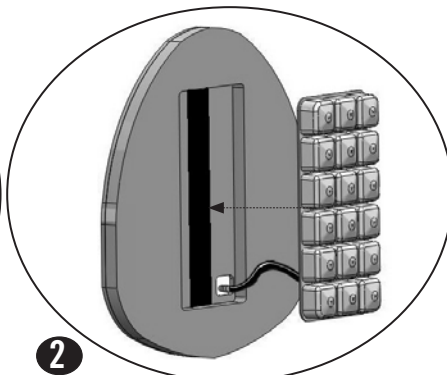

**2** Place the air insert into the cutout area of the foam pad.  
Secure the fabric back of the air insert to the fastener strip in the cutout area of the foam pad.

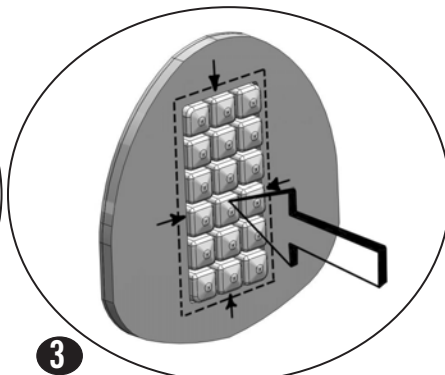

**3** Tuck the perimeter of the air insert between the foam layers just around the edge of the cutout area.

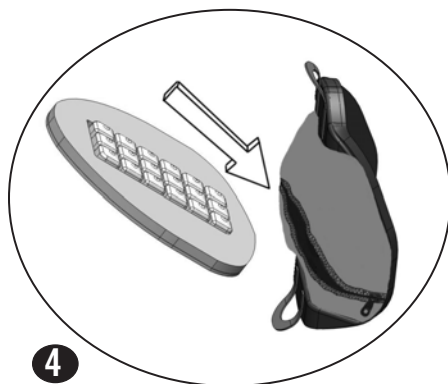

**4** Unzip the cover and place the foam pad with the air insert attached inside the cover.  
Note: The air insert should be facing the front of the cover. The wide and narrow ends of the foam pad should be aligned with the wide and narrow ends of the cover.



**5a** **a. If adjustment of the air insert is NOT needed:**  
Place the valve hose inside the zipper area.  
Zip the cover closed.  
Install the cover on the back shell.



**5b** **b. If adjustment of the air insert is needed:**  
Partially zip the cover closed allowing access to the valve.  
Install the cover on the back shell.  
See TO ADJUST THE AIR INSERT.

### TO INSTALL THE FOAM PAD WITH FOAM INSERT:

1. Align the fastener strip on the back of foam insert with the fastener strip in the cutout area on the front of foam pad and press together to secure in place.
2. Unzip the cover and place the foam pad with the foam insert attached into the cover.  
Note: The side of the foam pad with the foam insert should face the front of the cover. The wide and narrow ends of the foam pad should be aligned with the wide and narrow ends of the cover.
3. Zip the cover closed.
4. Install the cover on the back shell.



## COVER COMPONENTS - AIR INSERT ADJUSTMENT



### CAUTIONS

#### • CHECK INFLATION AT LEAST ONCE A DAY!

- The air insert must be used with the air cells facing the front of the wheelchair.
- The individual's comfort level may be reduced if the air insert is:
  - not positioned correctly
  - not properly sized to the foam pad
  - under-inflated or over-inflated
- If the air insert does not appear to be holding air, see TROUBLESHOOTING. If the air insert is still not holding air, replace the air insert with the foam insert and contact ROHO, Inc. or your international distributor. See CONTACT INFORMATION.
- Changes in altitude may require adjustment to the air insert. Check the inflation level of the air insert when changing altitude.
- Keep the air insert away from sharp objects which may puncture the air cells and cause it to deflate.

- If the air insert has been in temperatures less than 32°F / 0°C and exhibits unusual stiffness, allow the air insert to warm to room temperature, then open corner air valve. Roll up the air insert and then unroll it until the polyurethane is soft and pliable again. Repeat adjustment instructions before using.

#### • DO NOT:

- use the air insert as a seat cushion.
- expose the air insert to high heat, open flames or hot ashes.
- use the valve as a handle to carry or pull the air insert.
- use the air insert as a water flotation device (e.g., a Life Preserver).
- use both the air insert and the foam insert together.
- use a pump, cover, foam pad or repair kit, other than those provided by ROHO, Inc., with an air insert. Doing so may void the product's warranty.

### TO ADJUST THE AIR INSERT:

**Notes:** Before adjusting the air insert, the cover with the foam pad and air insert must be correctly installed on the back shell. AGILITY must be correctly installed and adjusted on the wheelchair.

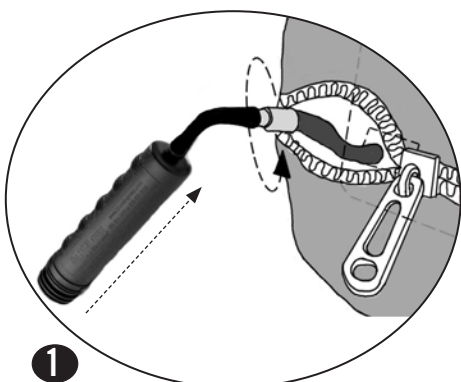

1

Slide the pump's nozzle over the valve and turn the valve **counterclockwise** to open. Inflate the air insert until the cells arch.

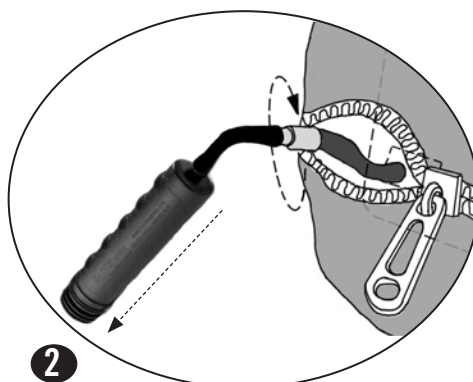

2

Pinch the pump's nozzle and turn the valve **clockwise** to close. Remove the pump.

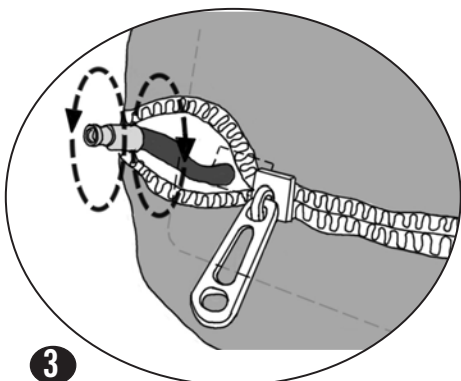

3

**! WARNING:** Safely transfer the individual into the wheelchair. The individual may be seated in the wheelchair in their normal position. Turn the valve **counterclockwise** to release air until the individual is comfortable. Turn the valve **clockwise** to close.

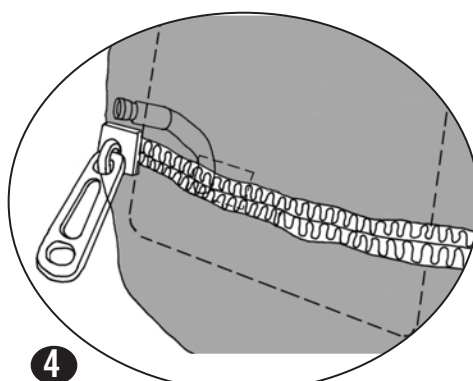

4

**! WARNING:** Safely transfer the individual out of the wheelchair. Detach the flap closest to the zipper. Place the valve hose inside the zipper. Zip the cover closed and reattach the flap.

## ACCESSORIES

### LUMBAR SUPPORT PAD:

The Lumbar Support Pad provides added support to the lumbar region. (Not included with all models.)

Package contents include hook and loop fastener strips. The hook side of the fastener strip is pre-attached to the back of the Lumbar Support Pad.

#### To Install a Lumbar Support Pad:

1. Detach the cover flap closest to the zipper and unzip the cover.
2. Place the lumbar support inside the cover positioned at the curve of the spine, or where it is most comfortable.

**Notes:** The Lumbar Support may be placed either in front of or in back of the foam pad.

Placement behind the foam pad is recommended for models with the air insert.

Placement in front of the air insert may reduce the performance of the air insert.

3. Remove the backing from the loop side of the fastener strip and secure the lumbar support pad in the desired position.

**Note:** If the loop fastener strip is attached to the inside of the cover, the fastener strip may need to be replaced after multiple cover washings.

4. Zip the cover closed and re-attach the cover flap.

#### To Remove a Lumbar Support Pad:

1. Detach the cover flap closest to the zipper and unzip the cover.
2. Carefully detach the hook and loop fastener strips from each other.

### HEADREST:

**Note:** Before installing another manufacturer's headrest, consult with a clinician or service provider to ensure the headrest is compatible with AGILITY.



**WARNINGS:** DO NOT install a headrest to an AGILITY with the individual in the chair.

Pay attention to all WARNINGS and CAUTIONS listed in the AGILITY Back Systems Operation Manual when installing another manufacturer's headrest.

AGILITY has not been tested with a third-party headrest installed. If a headrest is necessary, follow the headrest manufacturer's instructions and safety information.



**CAUTION:** Altering an AGILITY, including, but not limited to, drilling additional holes, to install another manufacturer's headrest may void the AGILITY warranty.

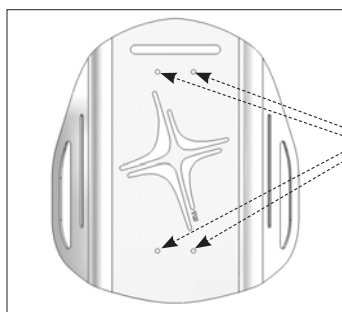

Pre-drilled holes for attaching a universal headrest mount.

**Note:** Pre-drilled holes not available on AGILITY models 10 in. (25.5 cm) in height.

**To Install a Headrest,** refer to the manufacturer's product information and instructions supplied with headrest.

### OTHER ACCESSORIES:

Refer to the product information included in the package with other ROHO accessories.

## CLEANING AND DISINFECTING























Cleaning and disinfecting are two separate processes. Cleaning **MUST** precede disinfection.

**Note:** Product **MUST** be cleaned, disinfected, and checked for proper functioning between use by different individuals.

 **WARNING:** If instructed to use bleach, follow safety guidelines on bleach container.

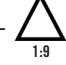
 **CAUTION:** **DO NOT** use abrasives such as steel wool or scouring pads on components of AGILITY.  
**DO NOT** use cleaning products containing petroleum or organic solvents [i.e. acetone, toluene, Methyl Ethyl Ketone (MEK), naphtha, dry cleaning fluids, adhesive removers] on components of AGILITY.

 = Wipe with damp cloth

AGILITY Component	To Clean:	To Disinfect:
<b>Back shell, back shell hardware and back cane hardware:</b>	  Hand wash in warm (40°C) water with soap and a sponge. Rinse with clean water. Wipe dry with a clean cloth and then allow to air dry completely.	  Wipe gently with a cloth dampened with a household disinfectant. Rinse with clean water. Wipe dry with a clean cloth and then allow to air dry completely.
<b>Cover:</b> <b>Notes:</b> Remove the foam and air components from the cover prior to cleaning and disinfecting. Secure the hook and loop fastener strip on the handle at the wide end of the cover. Turn the cover inside out. Zip the cover closed to avoid snags.	  Machine wash in warm (40°C) water with mild detergent. Tumble dry low.	 +  or   Hand wash in warm (40°C) water using 1 part household liquid bleach per 9 parts water. Rinse thoroughly with clean water. The cover may also be machine washed in hot (60°C) water to disinfect. Tumble dry low.
<b>Foam pad, foam insert and lumbar support pad:</b> <b>Note:</b> Remove the foam components from the cover prior to cleaning.	  Wipe lightly with a damp cloth. <b>DO NOT</b> use soap. <b>DO NOT</b> submerge in water. Wipe off with a clean cloth. Completely air dry before replacing in cover.	<b>Note:</b> Disinfectants are <b>NOT</b> effective on porous surfaces such as foam. Replace soiled or contaminated foam components with authorized ROHO foam components only. Replacement foam components may be purchased separately. Soiled or contaminated foam components <b>MUST NOT</b> be used by different individuals.
<b>Air insert:</b> <b>Notes:</b> Remove the air insert from the cover and foam pad prior to cleaning and disinfecting. Make sure the valve is closed. <b>DO NOT</b> allow water or cleaning solution to enter the air insert.	     Place in large sink or basin with warm (40°C) water. ROHO, Inc. recommends using a mild hand-washing or dish-washing liquid, laundry detergent, or other multipurpose detergents used for general cleaning. Use a soft, plastic bristle brush, sponge, or washcloth to gently scrub all cushion surfaces. Rinse with clean water. Air dry. <b>DO NOT</b> machine wash or dry. <b>DO NOT</b> expose to direct sunlight.	 +     Hand wash in warm (40°C) water using 1 part household liquid bleach per 9 parts water. Rinse thoroughly with clean water. Air dry. <b>DO NOT</b> machine wash or dry. <b>DO NOT</b> autoclave.

## MAINTENANCE

Check AGILITY screws, clamps, and brackets for wear, breakage, and tightness daily. Retighten loose screws following instructions throughout this manual.

**! WARNING:** **DO NOT** continue to use an AGILITY if any part cannot be tightened or is broken. ROHO, Inc. recommends that an AGILITY be thoroughly inspected periodically by a qualified technician.

## DISPOSAL

When properly used and disposed of, there are no known environmental hazards associated with the components of the product in this manual. Dispose of the product and/or components in accordance with the applicable regulations in your jurisdiction. **DO NOT INCINERATE.**

## TROUBLESHOOTING

**Problem installing or adjusting AGILITY, check the following:**

### BACK CANE HARDWARE INSTALLATION:

1. Make sure that both the left (L↑) and right (↑R) back cane brackets are in line with the frame of wheelchair and are not twisted.
2. Make sure that the heights of both the left (L↑) and right (↑R) back cane brackets are equal. Use a tape measure or ruler, if necessary.
3. The normal installation location of the back cane brackets is on the back side of the back canes. If a rigidizer bar interferes with the back cane brackets installed in the normal location, the back cane brackets may be installed on the front side of the back canes. In either orientation, the left (L↑) and right (↑R) directional markers on the back cane brackets should be correctly located from the viewpoint of the installer.

### AGILITY INSTALLATION:

1. Make sure that both the left (L↑) and right (↑R) back cane brackets are in line with the frame of wheelchair and are not twisted.
2. Make sure that the width is set appropriately for the chair. Back cane widths may vary. Back shell hardware is factory installed to accommodate most wheelchairs. If back shell hardware will not hook to the upper and lower pins of the back cane brackets, or if latches will not close, a width adjustment may be needed. Adjust the width as described in WIDTH AND HEIGHT ADJUSTMENT. It may take a few attempts to find the ideal width position for your chair.
3. If latches will not close, check to see if safety locks are in the LOCKED (🔒) position. Safety locks should be in the UNLOCKED (🔓) position to install AGILITY, and then LOCKED (🔒) prior to the individual being seated in the chair.

### WIDTH AND HEIGHT ADJUSTMENT:

1. Make sure the left (L) and right (R) back shell hardware are on the correct side.
2. Make sure the width and height adjustment bolts are positioned the same within the horizontal slots in the triangle brackets. Use the reference grooves above and below the horizontal slots on the triangle brackets as guides.
3. Make sure the left (L) and right (R) back shell hardware are positioned the same in the vertical slots on the back shell. Count the number of square slots in the sliding height adjustment bar that are visible through the vertical slots in the back shell.

### DEPTH AND ANGLE ADJUSTMENT:

1.  If a triangle bracket will not slide, make sure the slider nut is not in position to interfere. Adjust slider nut position if necessary.
2. Make sure that the left (L) and right (R) depths are equal. Compare the markers on the top of the triangle brackets.
3. Make sure that the left (L) and right (R) double hooks are rotated to the same angle. Compare the markers on the front of both double hooks.

**Problem with the air insert, check the following:**

1. If the air insert is not holding air, make sure the valve is tightly closed by turning the valve clockwise. If still not holding air, visibly check for holes. If no holes are visible, close the valve and immerse the air insert in a sink or tub of water and look for air bubbles. If 'pin-hole,' sized holes are found, air dry the insert completely and then use the repair kit that came with the product and follow the repair kit instructions. If large holes or other leaks are found, see LIMITED WARRANTY Section.
2. If the air insert is not comfortable, add or remove air to adjust to your comfort level. (see TO ADJUST THE AIR INSERT). Make sure air cells are facing the front of the wheelchair and the cover is properly positioned (see TO INSTALL THE COVER and TO INSTALL THE FOAM PAD WITH AIR INSERT).
3. If the air insert slides inside the cover, make sure it is properly positioned and the fabric back is secured to the fastener strip in the cutout area of the foam pad (see TO INSTALL THE FOAM PAD WITH AIR INSERT). The perimeter of the air insert should be tucked in between the foam layers around the edge of the cutout area.

## RETURN POLICY

All products returned must be new and unused and require prior authorization from ROHO Inc. and are subject to a restocking charge. Before returning a product:

**In the U.S.A.**, contact the ROHO, Inc. Warranty Service Department.

**Outside of the U.S.A.**, contact your country's ROHO International distributor.

## CONTACT INFORMATION

**In the U.S.A.:**

**ROHO Warranty Service and Customer Service:**

Phone: 1-800-851-3449 Fax: 1-888-551-3449

Warranty Service: [warranty@therohogroup.com](mailto:warranty@therohogroup.com)

Customer Service: [cs@therohogroup.com](mailto:cs@therohogroup.com)

**Note:** If directed to return any items, please send to:

ROHO, Inc.

1501 South 74th Street

Belleville, IL 62223

**Outside the U.S.A.:**

**ROHO International:**

[intl@therohogroup.com](mailto:intl@therohogroup.com) Phone: 1-618-277-9150 Fax: 1-618-277-6518

Or visit [www.therohogroup.com](http://www.therohogroup.com) for a list of ROHO International distributors.

## LIMITED WARRANTY

**What is covered?**

ROHO, Inc. covers any defects in materials or workmanship of the product.

**For how long?**

From the date the product was originally purchased:

<b>AGILITY Components</b>	Back Shell, Back Shell Hardware and Back Cane Hardware	- 36 months
	Cover, Foam Pad, Foam Insert and Lumbar Support Pad	- 18 months
	Air Insert	- 18 months

**What is not Covered?**

A product that has been misused, damaged by an accident, or damaged from "an act of Nature", e.g., flood, tornado, earthquake, fire. Any substitutions of supplied product accessories or modification to the product will void the warranty.

**What the customer must do.**

**Within the U.S.A.**, the customer must contact the ROHO, Inc. Warranty Service Department. **Note:** Any items sent to ROHO, Inc. without prior authorization will not be returned to the customer. **Outside the U.S.A.**, contact your country's ROHO International distributor.

**Questions?**

See CONTACT INFORMATION.

**Disclaimer.**

Any implied warranties, including the MERCHANTABILITY AND FITNESS FOR A PARTICULAR PURPOSE are limited to the same time period of the product types referenced above in the "For How Long" section and any action for a breach of such warranties or any express warranties herein must be commenced within that time. ROHO, Inc. shall not be responsible for any incidental or consequential damages with respect to economic loss to property, whether as a result of a breach of express or implied warranties or otherwise.

**Your Rights and the Effect of this Warranty upon Them.**

This warranty restricts the duration of all implied warranties as noted above and limits or excludes recovery for incidental or consequential damages. Some jurisdictions do not allow limitations on how long implied warranties will last and some jurisdictions do not allow the exclusion or limitation of consequential or incidental damages, so those provisions may not apply to you. While this warranty gives you specific legal rights, you may also have other rights which vary from jurisdiction to jurisdiction.

171-OM-2012  
Item # T20218 ----, Qty \_\_\_\_\_  
Revision: 041714  
Print Date: \_\_\_\_\_



The Quality Management System  
of ROHO, Inc. is certified to  
ISO 9001:2008 and ISO 13485:2003.

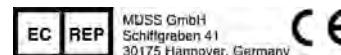

**A PRODUCT SUPPORTED BY:**



**Mailing/Shipping Address:**

1501 South 74th Street, Belleville, IL 62223-5900, USA

**Administrative Offices:**

100 North Florida Avenue, Belleville, IL 62221-5429, USA

**[www.therohogroup.com](http://www.therohogroup.com)**

U.S.: 1-800-851-3449 Fax 1-888-551-3449

Outside U.S.: 1-618-277-9150 Fax 1-618-277-6518