

# 2 PRODUCTS IN 1



ROLLATOR

745R



TRANSPORT CHAIR

## COMES WITH SWING-AWAY FOOTRESTS! Diamond Deluxe Aluminum Rollator/Transport Chair

745R Deluxe, Cherry Red, 1/cs  
745B Deluxe, Marine Blue, 1/cs

### FEATURES:

- Transport chair and rollator in one.
- Easily converts from a rollator to a transport chair.
- Comes with Tool Free adjustable swing-away footrests.
- Tool free removable front and rear wheels.
- Dual cross brace provides added strength.
- Durable mesh back rest.
- Comes with removable carry pouch.
- Large 8" casters are used for indoor & outdoor use.
- Comfortable mesh seat.
- Handles are height adjustable.
- Soft, comfortable grips.
- Easy to use loop locks.
- Limited Lifetime Warranty.



DUAL CROSS BRACE PROVIDES ADDED STABILITY!



Cherry Red

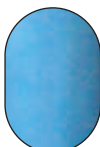

Marine Blue



740R



RED BUTTON RELEASES WHEEL FOR EASY AND CONVENIENT REMOVAL



### Diamond Aluminum Rollator

740R Cherry Red, 1/cs  
740B Marine Blue, 1/cs

### FEATURES:

- Tool free removable front and rear wheels.
- Durable mesh back rest.
- Comes with removable carry pouch.
- Large 8" casters are used for indoor & outdoor use.
- Comfortable mesh seat.
- Handles are height adjustable.
- Soft, comfortable grips.
- Easy to use loop locks.
- Limited Lifetime Warranty.

SEE PAGE 52 & 53 FOR REPLACEMENT SEATS.

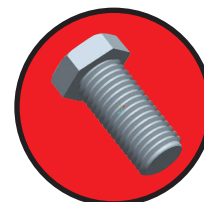

PARTS DIAGRAMS ON PAGE 65 & 66

### SPECIFICATIONS

Item #	Handle Height (highest)	Handle Height (lowest)	Unit Width	Unit Length	Seat (depth)	Seat (width)	Seat (height)	Product Weight	Carton Shipping Weight	Weight Limit
DIAMOND DELUXE	37.5"	31.5"	24"	25.5"	9"	18"	21"	18 lbs.	23 lbs.	300 lbs..
DIAMOND	37.5"	31.5"	24"	25.5"	9"	18"	21"	18 lbs.	23 lbs.	300 lbs.

\*Important Notice: Item numbers that display an asterisk (\*) reflect an item that will be discontinued or package change.

rollators

drive  
WWW.DRIVEMEDICAL.COM

To order call toll free: 877.224.0946